

D2000.SH Curve LED downlight Datasheet



Product codes

Unit: D2000.SH	Series: CR	Colour temp. (K): 3K 4K	Beam angle (°): 55	Colour: B (Black) W (White)
--------------------------	----------------------	--------------------------------------	------------------------------	--

Photometrics

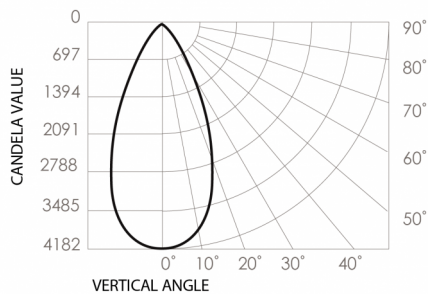

Source lumen output: 2100lm
Delivered lumen: 2000lm
Efficacy: 83lm/W
Colour temp.: 3000K
Beam angle: 55°
CRI: 95

Dimensions (mm)

Front view

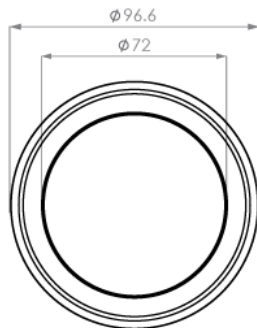

Side view

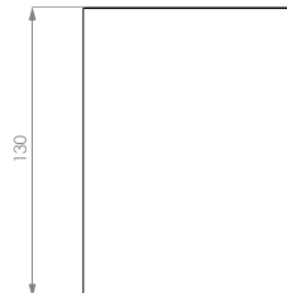

Electrical

Input voltage:
220-240V

Power usage:
24W

Driver power factor: >0.95
IP rating: IP44

Surge protection:
3100V

Dimmable:
Yes

Operational

Ambient temp.:
-28 to 65°C

Lifetime L70, B10:
70,000 hrs (@TA25)

Source Lumens:
2100lm or 2140lm

Physical

Weight:
700g

Gimbal angle:
N/A

Warranty:
7 years

Installation

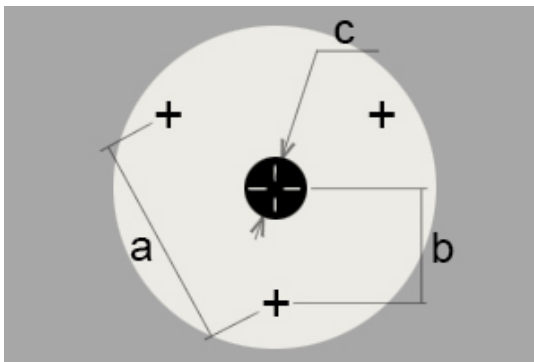

Step 1

Unscrew the 3 grub screws from the side of the product to release the base plate. Using the base plate as a guide, pilot hole the points where the 3 mounting screws will be drilled in.



Step 2

Thread the power cable through the base plate and align the base plate to the ceiling. Fasten the base plate to the ceiling using the 3 mounting screws.

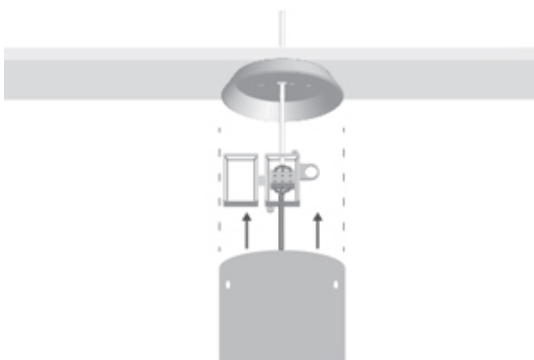

Step 3

Remove the junction box from the back of the luminaire. Open the junction box and connect the power cable.

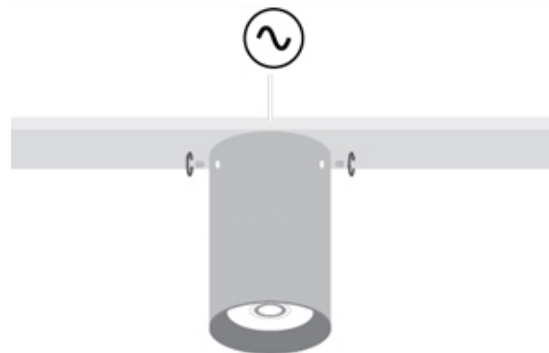

Step 4

Reattach the cover of junction box and return it into the luminaire. Ensure the luminaire to the base plate using the grub screws.

Installation



Step 5
Installation complete.