

# W500.IPS Cube LED wall light

## Datasheet



### Product codes

<b>Unit:</b> W500.IPS	<b>Series:</b> CB	<b>Colour temp. (K):</b> 3K	<b>Beam angle (°):</b> 33	<b>Colour:</b> GM (Gun Metal)
--------------------------	----------------------	--------------------------------	------------------------------	----------------------------------

### Photometrics

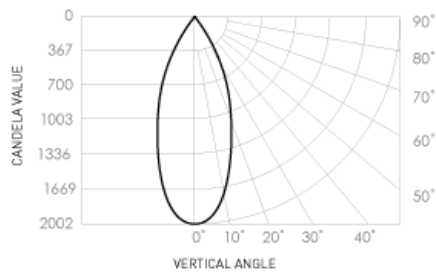

**Source lumen output:** 690lm  
**Delivered lumen:** 570lm  
**Efficacy:** 66lm/W  
**Colour temp.:** 3000K  
**Beam angle:** 33°

### Dimensions (mm)

Front view

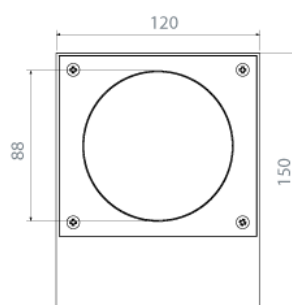

Side view



## Electrical

**Input voltage:**  
220-240V

**Power usage:**  
8.7W

**Driver power factor:** 0.85

**IP rating:**  
IP54

**Surge protection:**  
Yes

**Dimmable:**  
No

## Operational

**Average temp.:**  
65°C

**Ambient temp.:**  
-28 to 60°C

**Lifetime L70, B10:**  
70,000 hrs (@TA25)

**Source Lumens:**  
690lm

## Physical

**Gimbal angle:**  
N/A

**Warranty:**  
3 years

## Installation

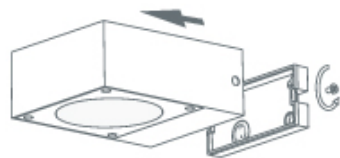

### Step 1

Unscrew the grub screws from the sides of the luminaire housing to release the base plate.

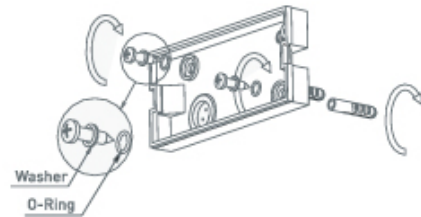

### Step 2

Thread the power cable through the base plate, use the base plate as a guide to drill 3 pilot holes for the wall plugs. Once wall plugs have been pressed into the wall fasten the base plate to the wall using the screws provided

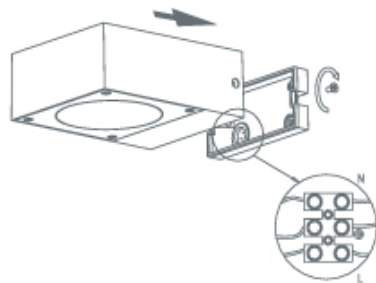

### Step 3

Connect the mains power cable to the terminal block.

Position the luminaire housing back to base plate and secure by putting back the grub screws.

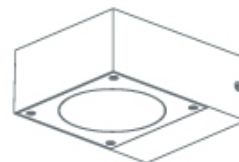

### Step 4

Installation complete.