

# W900.SX-CB LED wall light

## Datasheet



### Product codes

<b>Unit:</b> W900.SX	<b>Series:</b> CB	<b>Colour temp.:</b> 3K	<b>Beam angle (°):</b> 180.20	<b>Colour:</b> S (Silver) W (White)
-------------------------	----------------------	----------------------------	----------------------------------	---

### Photometrics

#### Standard Products

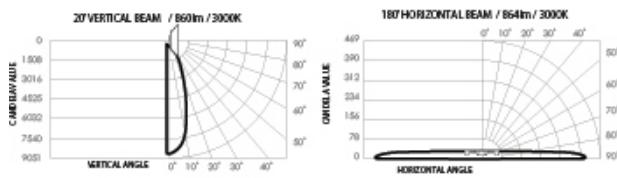

Source lumen output: 1080lm  
Delivered lumen: 900lm  
Efficacy: 60lm/W  
Colour temp.: 3000K  
Beam angle: 180/20°

## Dimensions (mm)

---

Front view

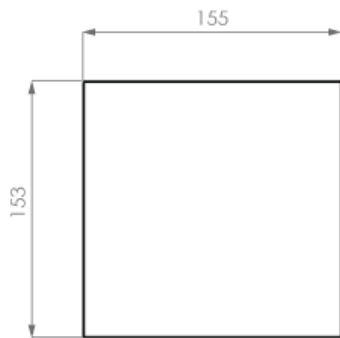

Side view

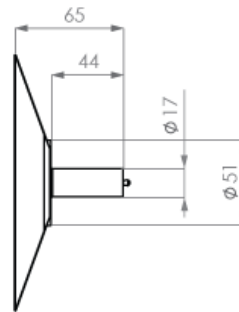

## Electrical

<b>Input voltage:</b> 48V	<b>Power usage:</b> 15W	<b>Driver power factor:</b> >0.9	<b>IP rating:</b> IP22	<b>Surge protection:</b> 3100V
<b>AC Cable length:</b> 1.5m	<b>Dimmable:</b> No	<b>Driver:</b> BG-030ND-830mA (sold separately)		

## Operational

<b>Operating temp.:</b> -20 to 90°C	<b>Average temp.:</b> 60°C	<b>Ambient temp.:</b> -28 to 70°C	<b>Lifetime L70, B10:</b> 40,000 hrs (@TA25)	<b>Source Lumens:</b> 1080lm
--	-------------------------------	--------------------------------------	---	---------------------------------

## Physical

<b>Gimbal angle:</b> 20° Universal	<b>Warranty:</b> 7 years
---------------------------------------	-----------------------------

## Compatibility

**Recommended Dimmers:**  
BG-030ND - 30W compact, non-dimmable driver available. Compatible with 1-2 W900.SX and/or 1-4 W200.SX

## Installation

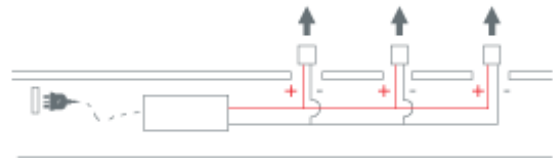
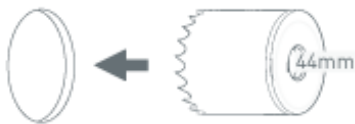

### Step 1

Using a 44mm hole saw, cut a cavity in the wall at the desired installation location.

### Step 2

Remotely mount the BG-030ND driver (not included) and plug into a mounted general power outlet (GPO) in the wall. Note: You can use 1 driver to power 2 units. Wire the driver to the power cable and thread through the wall. Where necessary, daisy chain in parallel multiple luminaires (Max. recommended cable distance between the driver and luminaire is 1.5m)

## Installation

---

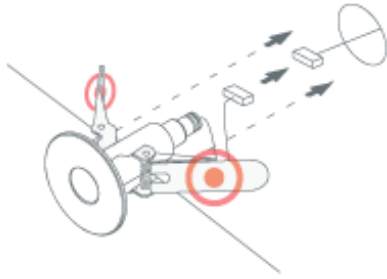

### Step 3

Connect the flying lead from the W900 SX Cube base to the low voltage luminaire cable. Pull back the springs and insert the luminaire into the wall cavity

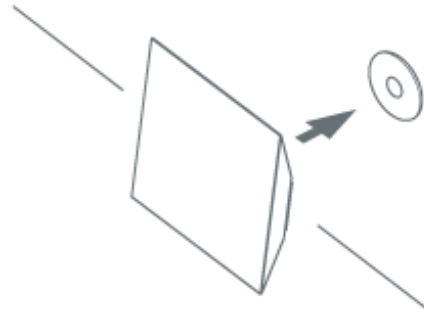

### Step 4

Insert W900 SX Cube luminaire into its base until the unit clicks into position.